

KR 2391A-10-75 Lowpass Filter

General Description

KR 2391A-10-75 is a group delay equalized lowpass filters. The filter's flat passband response and group delay equalization make it a good choice for video applications.

Features

- Flat passband response
- Group delay equalized

Typical Performance

Passband Response $f_c=10$ MHz
(0.25 dB/div & 10 nsec/div) 100 KHz to 11 MHz

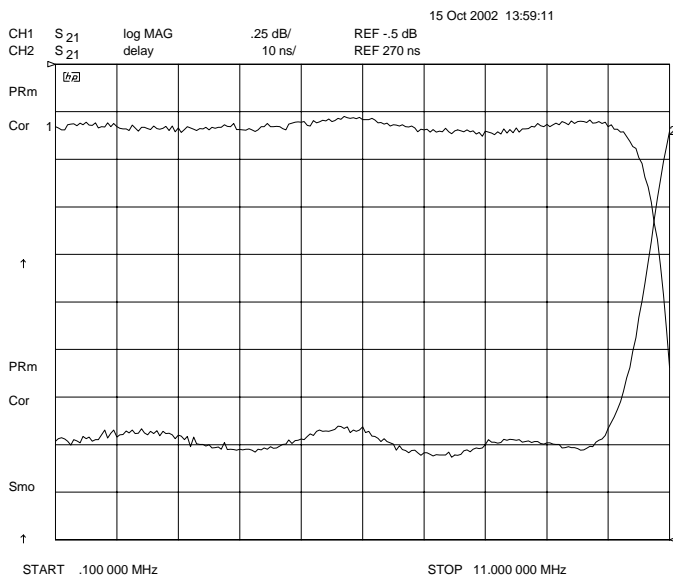

Figure 1

Overall Response $f_c=10$ MHz
(10 dB/div) 100 KHz to 50 MHz

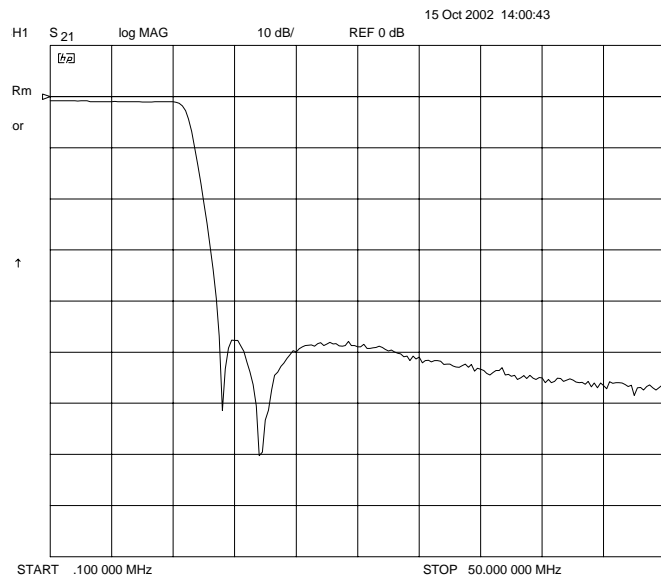

Figure 2

KR Electronics, Inc.
91 Avenel Street
Avenel, NJ 07001

Web www.krfilters.com
Email sales@krfilters.com
Phone (732) 636-1900
Fax (732) 636-1982

KR Series 2391A-10-75

Specifications

| Parameter | Specification |
|--------------------------|---------------|
| Filter type | Lowpass |
| Insertion Loss | < 1 dB |
| End of Passband (fc) | 10 MHz |
| Passband Ripple | < 0.25 dB |
| Attenuation at 1.1 x fc | < 3 dB |
| Attenuation at 1.38 x fc | > 45 dB |
| Group Delay Ripple to fc | < 10 nsec |
| Source and Load | 75 Ω |

Physical Dimensions

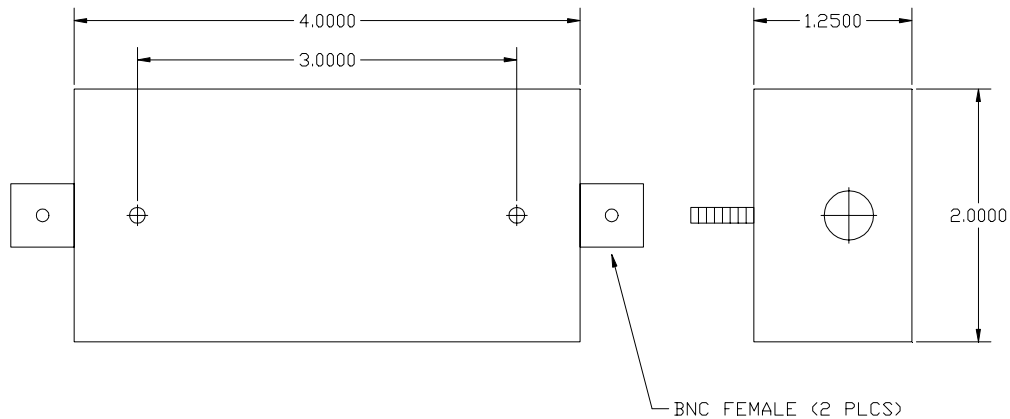

Also available in a 4 x 2 x 0.5 inch metal can
with PCB terminals
Other configurations available on request

All dimensions in inches

KR Electronics, Inc.
91 Avenel Street
Avenel, NJ 07001

Web www.krfilters.com
Email sales@krfilters.com
Phone (732) 636-1900
Fax (732) 636-1982